

Symbol	Dimensions In Millimeters		Symbol	Dimensions In Micrometers	
	Min	Max		Min	Max
A	9.8	10.2	C	1.2	1.4
R	3.56	3.64	B	6.3	6.7
L	15.7	16.1	B1	9.0	9.4
b	12.6	13.6	C1	2.2	2.6
b1	9.6	10.6	a1	0.7	0.7
a	1.22	1.32	c	0.4	0.6
E	2.34	2.74	C2	4.3	4.7
a2	1.25	1.45			

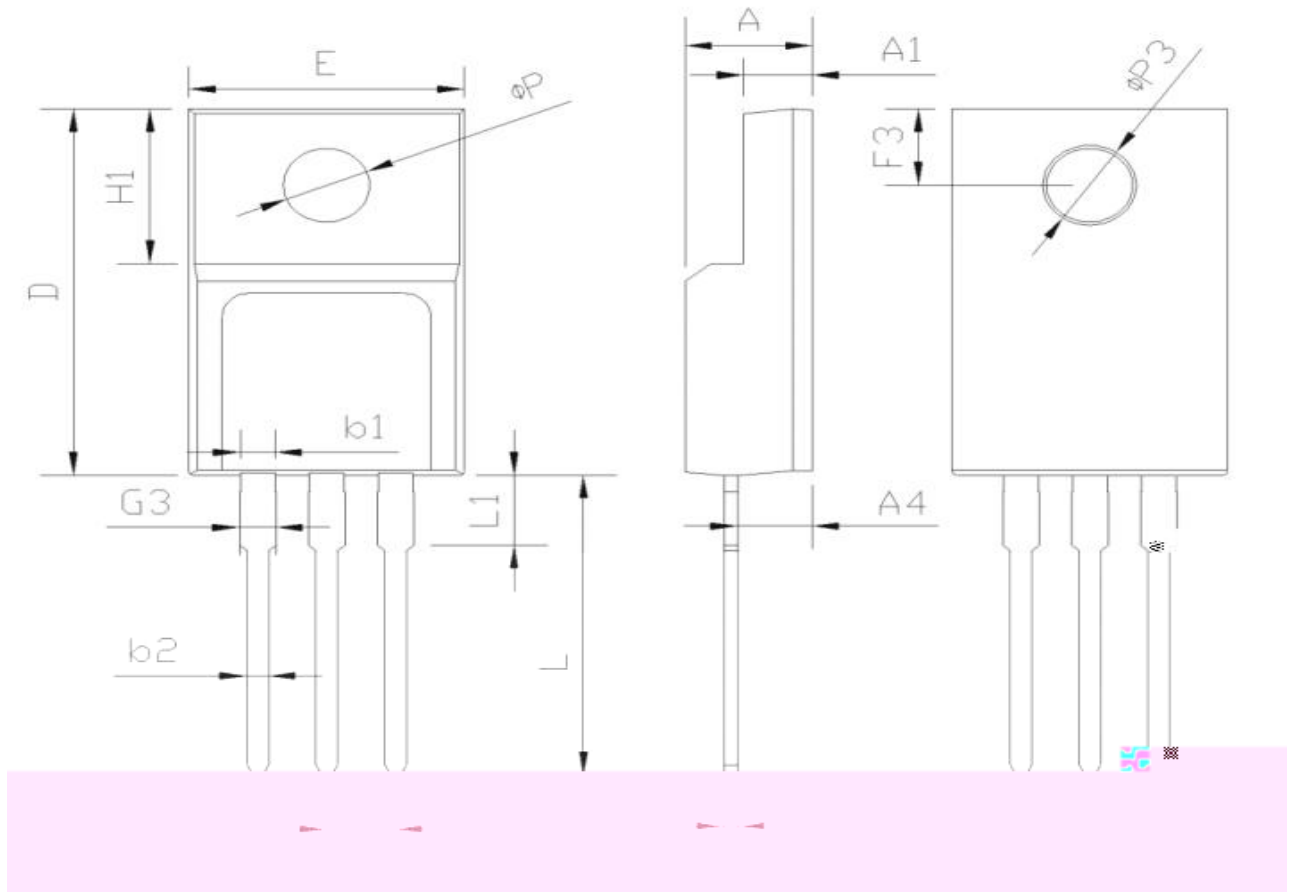

SYMBOL			
ΦP	12.68	12.98	13.28
L1	2.88	3.03	3.18
$\Phi P3$	3.03	3.18	3.38
F3	3.15	3.45	3.65
G3	3.15	3.30	3.45
b1	1.25	1.35	1.55
b2	0.70	0.80	0.95

